



hergom

Catalog 2016-2017

Stoves · Inserts · Fireplaces · Cookers





Enjoy the warmth of winter

From the dawn of time, fire, the most captivating of the four elements, has fascinated man with its mysterious nature and its capacity to create hypnotic and evocative atmospheres. Fire is also a synonym of heat, of dancing flames and shadows, of an intimate and pleasant place where one may seek refuge on cold winter days.

We invite you to get acquainted with our vast collection of freestanding stoves, inserts and fireplaces, starting on these pages. From rustic to modern, casual to formal, Hergóm is an ideal way to bring home a special warmth – to enjoy the warmth of winter.

The Hergóm Advantages

Founded in 1960, Hergóm is today one of the main manufacturers of hearth products worldwide. Through more than half a century, Hergóm has gained success and experience in developing wood and biomass heating appliances, focusing on natural fuels, through research, development and improvement of the efficiency of our products.

Today, the Hergóm brand is an assurance – a guarantee that your appliance is built in the rich tradition of our company, and will serve you faithfully for years to come. Your Hergóm purchase represents not only the latest in aesthetic advances, but also the utmost in powerful heating technology. It's this integrity that gives Hergóm products their unmatched appeal, and has for over 50 years.

Designs with personality.

Hergóm appliances are not only highly efficient, but also state-of-the-art products from an aesthetical point of view: elegant and long-lasting designs that enhance the decoration of any room with their personality. Hergóm has been nominated in Spain for the Prince Felipe Awards to Corporate Excellence in the Design section.



With the guarantee of our own foundry.

Owning a foundry, we use fine-cast iron as a primary source for our products. Here is why we believe cast iron is a such a great and resilient material for hearth products :

- Durability: given their resistance to heat and rust and thanks to their construction without welded points, that prevents damage of components that would break if made out of other materials. A cast iron body lasts virtually forever.
- Looks: cast iron allows for attractive and unique shapes and patterns.
- Thermal inertia: cast iron offers a gentle, cozy heat transfer, and a cast iron stove remains warm for several hours after the fire has gone out.
- Excellent performance/price ratio.



Commitment to quality.

We use selected raw materials and components in our production process in order to guarantee optimum performance and reliability. All Hergóm stoves and fireplaces meet UNE-EN-13229 standards that ensure thermal values and performance. Hergóm meets all Integrated Environmental Authorisation requirements since 24/12/2008.

Stoves



THE PLEASURE OF BRINGING BACK TIME

Fabricated entirely of top-quality grey cast iron shaped in a modern state-of-the-art moulding plant, our line of stoves sets the bar for quality. Exclusive design features ensure each appliance is economical and safe, providing clean and complete combustion for warmth you can trust. Whether it is classic painted iron or vitreous enamel glazed, our stoves are as beautiful as they are functional - with optimized fire viewing areas and distinctive character down to the last detail.

Fireplace inserts



MODERN EFFICIENCY AND CONVENIENCE

Everyday, more homeowners are in search of a solution to modernize their old, inefficient open fireplace. Hergóm has created a new range of compact inserts designed to be installed in new buildings, or to replace existing fireplaces. Our solutions enable you to continue enjoying fire as before, but with greater safety, comfort and efficiency. If you already had a fireplace, now you may have a Hergóm fireplace.

Sliding door fireplaces



EFFICIENT, OPTIMIZED FIRE-VIEWING

Hergóm's sliding door fireplaces are the perfect appliances to give a touch of warmth and distinction to your most appreciated living spaces. Their modern designs, balanced proportions and oversized glass surfaces allow for a unique fire-viewing experience. Glass frames slide smoothly upwards for an unobstructed vision of the fire. Additionally, door panels are hinged to allow you for an easy cleaning of the window panels. Most models feature a convection jacket and fans to drive hot air to other rooms.

Range cookers



CLASSIC ON THE OUTSIDE, INNOVATIVE INSIDE

Hergóm's wood fired cookers are designed and engineered to let you enjoy the best flavours of traditional cooking. Built in cast iron, and featuring large capacity ovens as well as ceramic glass tops reinforced with cast iron, our range cookers gather all the properties of a high quality product: technology, efficiency, sturdiness and elegance.

GLANCE



Available in free-standing and wall-mounted versions, the new Glance is designed to offer you the best fire viewing experience. Its innovative design introduces front and side ceramic glass vision panels with a modernistic style top and side surround bars. Being able to glimpse the fire from the sides as well as a clear frontal view makes the Glance all the more warming and comforting in the modern home.



Glance Free Standing



Glance Wall Mounted



Design: Strand + Hvaas

Located in Copenhagen, the work of Christina Strand and Niels Hvass design studio relies on the Nordic design tradition: keep it simple and clean. That's the reason Glance is user-centered and deeply rooted in the Scandinavian culture. Simplicity and well-balanced lines combine to make the Glance truly stands out from the norm.

- Free-standing and wall mounted option.
- Cast iron double structure.
- Vermiculite-lined firebox.
- Front and side ceramic glasses.
- Single lever primary air control.
- Secondary combustion system.
- Outside air inlet.
- Top and rear flue exit.
- Removable ash pan.

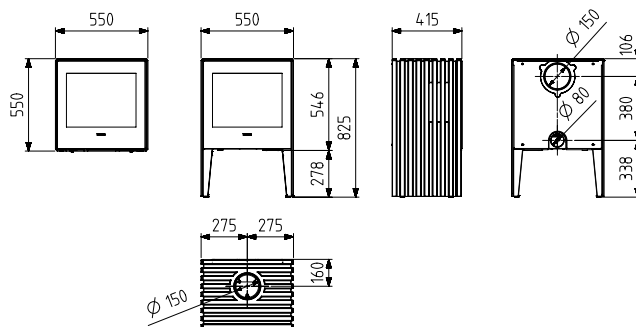

MANCHESTER



- All – cast, double – wall construction for a better efficiency and heat transfer.
- Soapstone-lined firebox.
- Airwash system- Self cleaning window.
- Double combustion (stainless steel refractory tubes).
- Front and side loading doors.
- Reversible flue collar for a top or rear exit.
- Ceramic baffle.
- Removable ash pan.
- Built-in cast iron rear heat shield.
- Outside air inlet (kit optional).
- Available in matte black, brown majolica enamel or ivory gloss enamel finish.

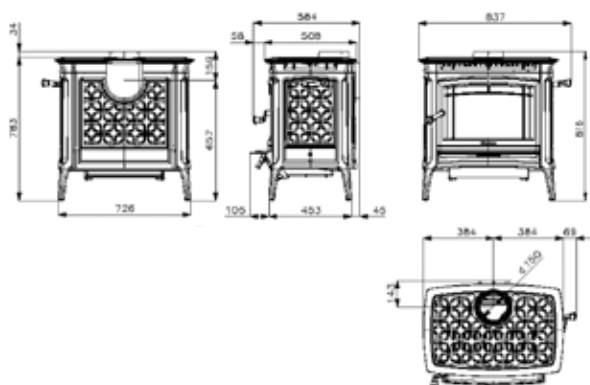



With a double-wall cast iron frame and built-in rear heat shield, the Manchester's large firebox actually serves as a convection chamber that allows air to circulate within, and then return, thoroughly warmed, into the room.



Integrated rear heat shield.



Side loading door.



Manchester Ivory Enamel.



Manchester Brown Enamel.



Manchester Matte Black.

BENNINGTON



With a double-wall cast iron frame and built-in rear heat shield, the Bennington's large firebox actually serves as a convection chamber that allows air to circulate within, and then return, thoroughly warmed, into the room.



- All – cast, double – wall construction for a better efficiency and heat transfer.
- Airwash system- Self cleaning window.
- Double combustion (stainless steel refractory tubes).
- Front and side loading doors.
- Reversible flue collar for a top or rear exit.
- Ceramic baffle.
- Removable ash pan.
- Built-in cast iron rear heat shield.
- Outside air inlet (kit optional).
- Available in matte black, brown majolica enamel or ivory gloss enamel finish.

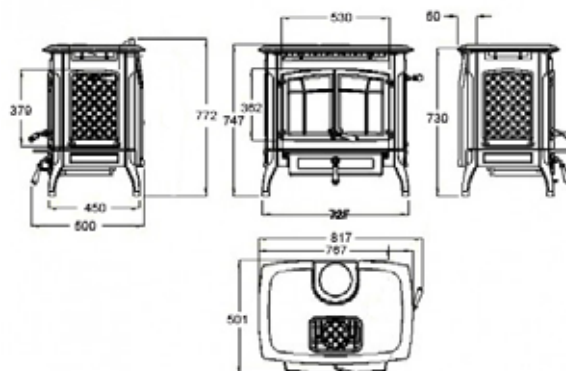

SHELBURNE



- Built in cast iron.
- Advanced double combustion technology.
- AirWash glass self-cleaning system.
- Top and rear flue exit.
- Outside air inlet.
- Removable ash pan.
- Available in matte black and brown majolica enamel finish.

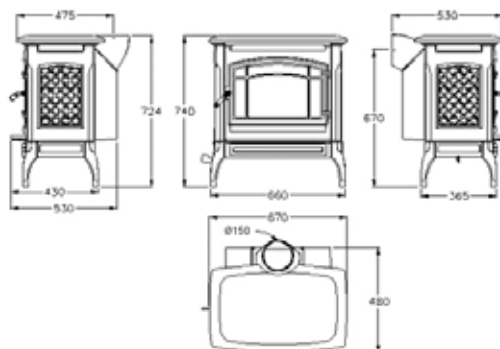

CRAFTSBURY

SEE IT BURNING

*Advanced double combustion air pipes.*

- Built in cast iron.
- Advanced double combustion technology.
- Soapstone-lined firebox.
- AirWash glass self-cleaning system.
- Top and rear flue exit.
- Outside air inlet.
- Removable ash pan.
- Available in matte black and brown majolica enamel finish.

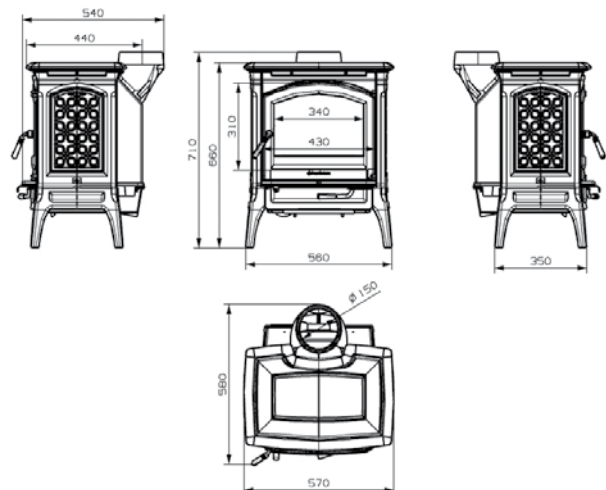

HERITAGE

Soapstone stove



Soapstone HeatLife™

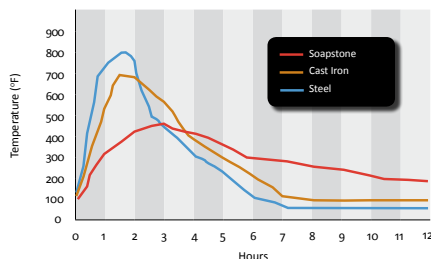

Thanks to its high efficiency and the heat retention properties of soapstone, the Heritage will provide you with hours of sustained heat when fully loaded.

Soapstone possesses extraordinary heat retention properties, being able to stay warm for hours releasing uniform, gentle heat long after the fire is out.

- Built in cast iron and natural soapstone, with extraordinary heat retention capability.
- Side loading door.
- Double combustion (stainless steel refractory tubes).
- AirWash glass self-cleaning system.
- Top and rear flue exit.
- Ceramic baffle.
- Removable ash pan.
- Outside air inlet (kit optional).

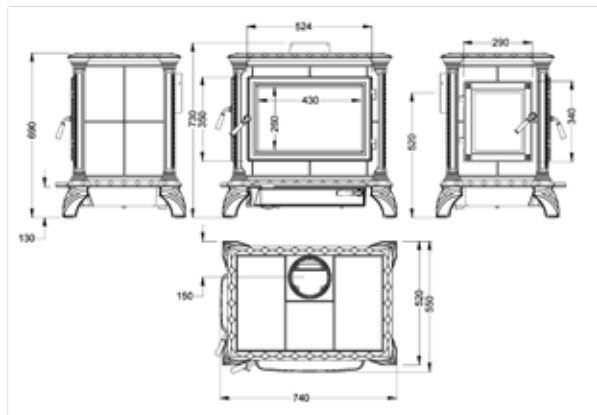

E-30

SEE IT BURNING



E-30 S

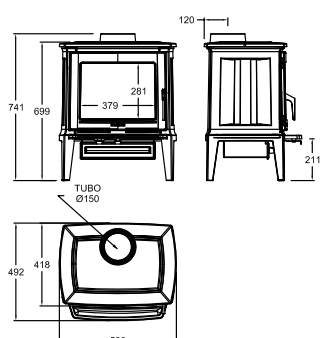

E-30 M

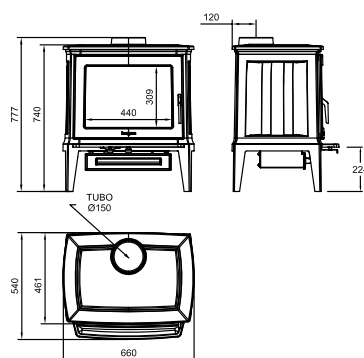

E-30 L

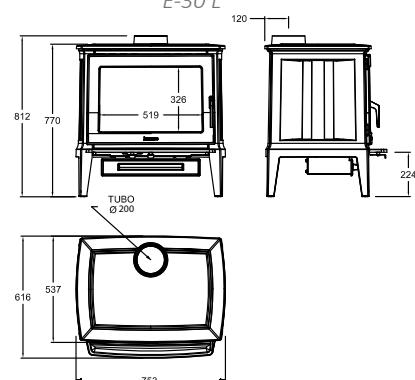

- Built in cast iron.
- Controlled provision of primary and secondary air for the combustion process.
- Removable ash pan.
- AirWash system - Self cleaning windows.
- Outside air inlet.
- Model E-30 M is available with rear flue exit.



E-30 XS

Multifuel



The cast iron riddling grate allows for a proper combustion of coal by preventing clinkers from piling up on the bottom of the firebox.

The new E-30 XS multifuel stove is designed to burn coal as well as wood, offering an efficient, optimum combustion with both fuels. Its compact size and configuration options make it ideal to install in existing hearths, offering a versatile and easy installation.



The E-30 XS may optionally be installed with long legs (158 mm).

- Built completely in cast iron.
- Multifuel stove: capable of burning coal and wood.
- Controlled provision of primary and secondary air for the combustion process.
- AirWash system - Self cleaning windows.
- Riddling grate.
- Removable ash pan.
- Top and rear flue exit.
- External air inlet.
- Also available with longer legs (158 mm).

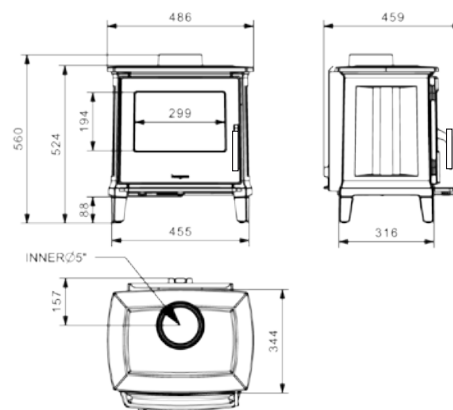

E-20 N



- Built in cast iron.
- Controlled provision of primary and secondary air for the combustion process.
- Removable ash pan.
- AirWash system - Self cleaning windows.
- Top and rear flue exit for flexible installations.

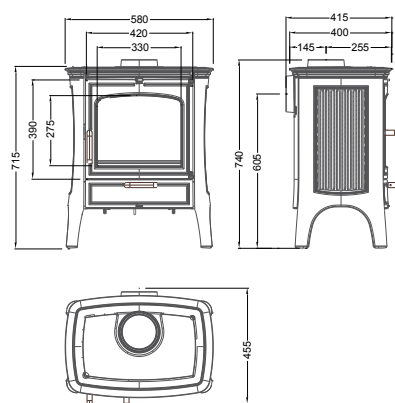

SANTORINI



- Built in steel.
- Large ceramic glass for a spectacular fire view.
- Self cleaning window through the Airwash system.
- Controlled provision of primary and secondary air for the combustion process.
- Double combustion.
- Outside air inlet.
- Removable ash pan.
- Free standing and wall mounted versions, optional decorative pipe cover.

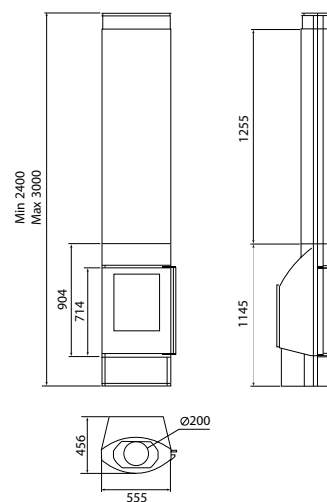



Santorini CFS



Santorini CP



Santorini FS



Santorini P



CRETA



- Steel construction.
- Large ceramic glass for a spectacular fire view.
- Self cleaning window through the Airwash system.
- Controlled provision of primary and secondary air for the combustion process.
- Removable ash pan.
- Hanging and wall-mounted configurations.

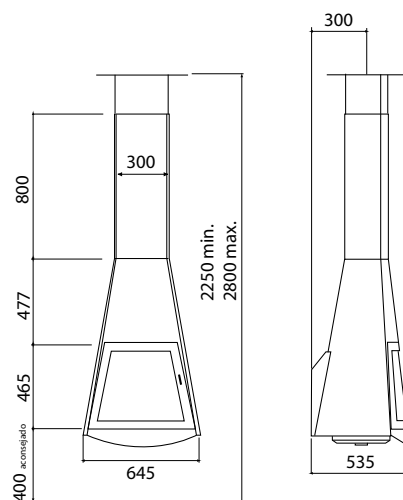

MALLORCA



- Steel construction.
- Large ceramic curved glass for a spectacular fire view.
- Rotating base for wood loading.
- Firebox equipped with surrounding lights.
- Draft control.
- Removable ashpan.

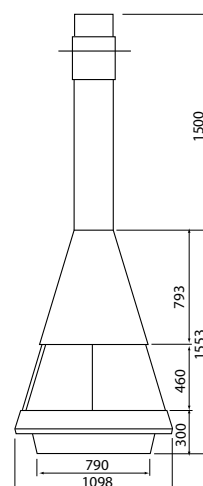

LAREDO



Laredo R

The Laredo R model is specifically designed to be installed in a corner.

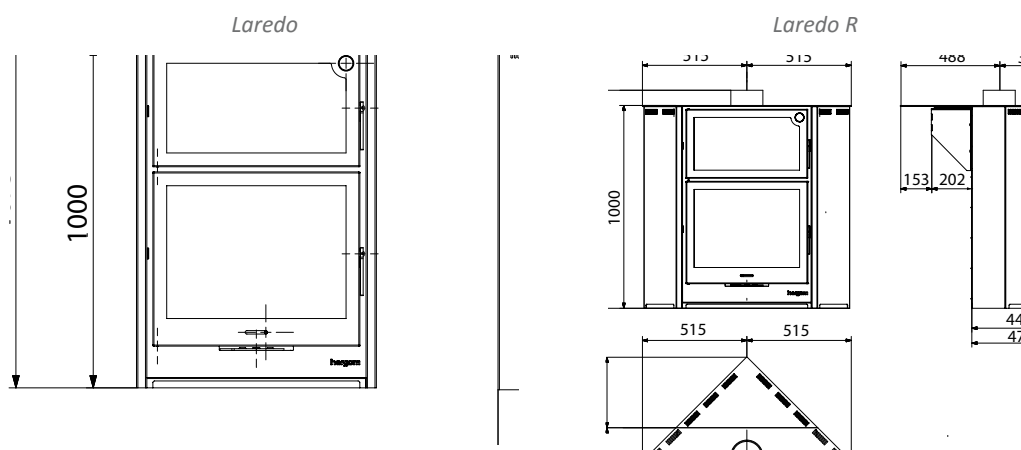



- Big capacity oven in stainless steel, 2 mm thick.
- Removable oven for an easy cleaning and maintenance.
- Double wall construction for convective hot air circulation and oven heating.
- Outstanding combustion values: 80% efficiency, and 0,09% CO emissions.
- Primary and secondary air controls. Responsive, gradual air control handle.
- Glass remains clean thanks to the Airwash system.
- 2 grill positions in firebox and oven. Grills are removable to ease the cleaning process.
- Removable ash pan.

NATURE

SEE IT BURNING



Firebox options



Cast iron



Refractory

Frames



4 Sided



3 Sided

Nature 70

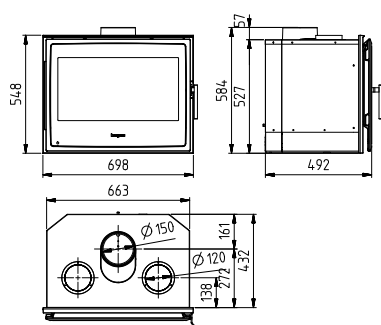

Nature 80

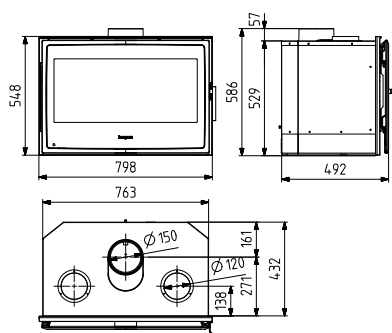

Nature 100

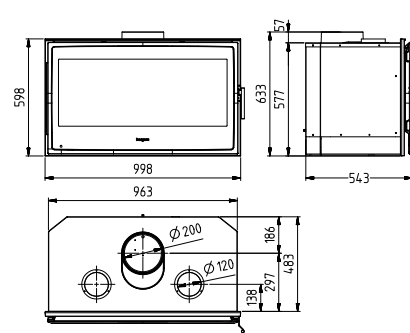

- Cast iron fireplace insert.
- Convection blower.
- Double combustion.
- Airwash glass cleaning system.
- Cast iron or refractory brick interior.
- Remote air and blower controls.
- Outside air inlet.
- Adjustable flue connection.
- Removable ash pan.



Nature inserts allow you to adjust combustion air flow easy and conveniently through the remote control. Featuring an auto mode, the appliance adjusts automatically the air intake according to its temperature, optimizing its efficiency and protecting it from overheating.

SERE



Firebox options



Cast iron



Vermiculite

Frames



Frame 1



Frame 2



Frame 3

Frame 1: 4 sides 90 mm wide, 12 mm deep.
 Frame 2: 1 side 90 mm wide, 3 sides 50 mm wide, 12 mm deep.
 Frame 3: 1 side 90 mm wide, 3 sides 50 mm wide, 1 mm deep.

- Steel fireplace inserts.
- Convection blower.
- Convection air outlets.
- Secondary combustion.
- Airwash glass cleaning system.
- Cast iron or vermiculite interior.
- Removable ash pan.



Sere 70

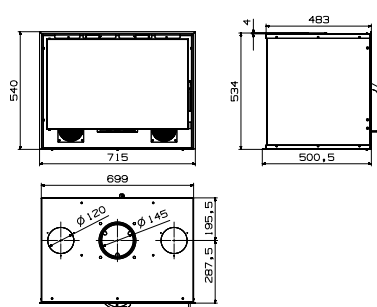

Sere 80

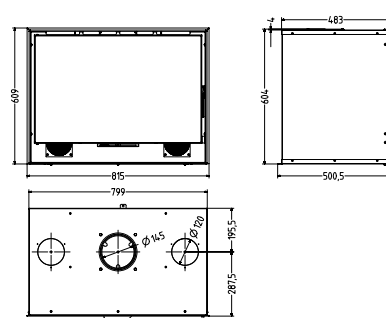

Sere 100

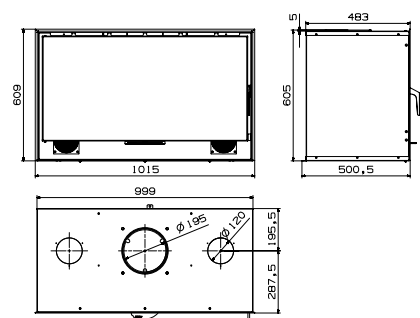

SERE 100 2C

The Sere 100 2C fireplace insert features 2 glass doors that allow you to enjoy the fireview from two different rooms, or from two different areas in the same room. Wood can be loaded from both sides.



- Steel fireplace inserts.
- 2 sided view with 2 ceramic glass doors that can be opened from both sides.
- Convection blowers.
- Convection air outlets.
- Secondary combustion.
- Airwash glass cleaning system.
- Removable ash pan.
- Optionally available for natural convection (no blowers).

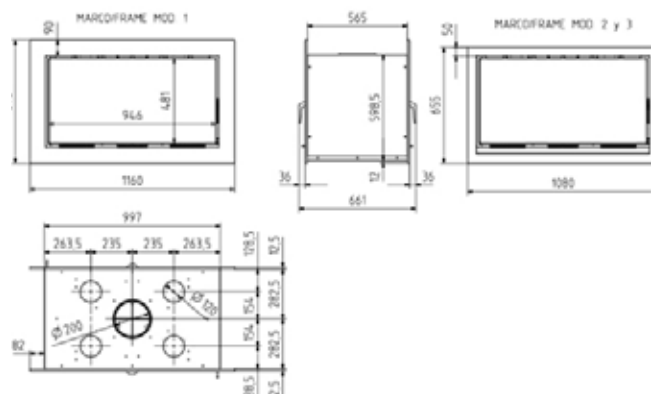

HGB-70



- Built completely in cast iron.
- Aiwash glass cleaning system.
- Primary air regulation.
- Front ceramic glass.
- Removable ash pan.
- Outside air inlet (optional).
- Draft valve.

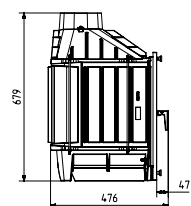
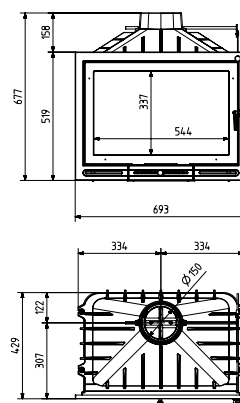

STILKAMIN



Stilkamin S-460

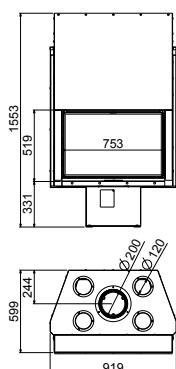

Stilkamin S-600

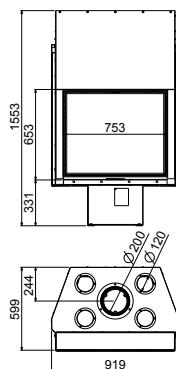

Stilkamin L

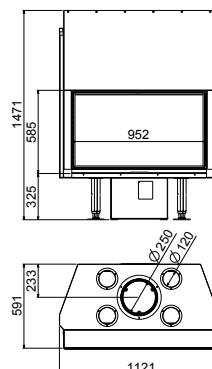

Stilkamin XL

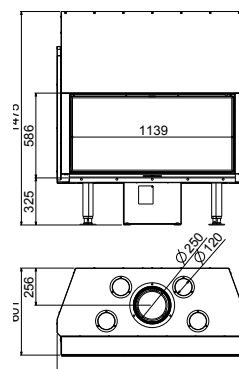



FRAME OPTIONS

- Sliding door fireplaces, built in steel.
- Ceramic refractory and cast iron firebox interior.
- Ceramic glass.
- Convection jacket and air outlets.
- Convection blower (optional).
- Removable ash pan.



4 Sides



3 Sides



Convection
blower
(optional)

ECK



ECK (left configuration).

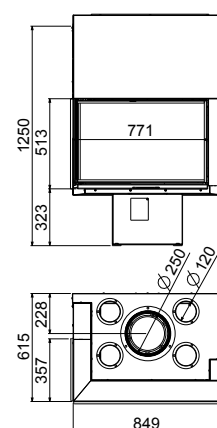



- Sliding door fireplaces, built in steel.
- 1 piece L-shaped ceramic glass.
- Ceramic refractory and cast iron firebox interior.
- Convection jacket and air outlets.
- Convection blower (optional).
- Removable ash pan.
- Available in left/right configurations



ECK (right configuration).

CARES



Cares (rear flue exit)



Cares II (top flue exit)





- Porcelain enamel cast iron front.
- Liftable ceramic glass with underlying enamelled cast iron cook top.
- Rear or top flue exit option.
- Front draft valve.
- Gradual air control.
- External air inlet.
- Stainless steel oven with chrome grill.
- Storage drawer.
- Removable ash pan.

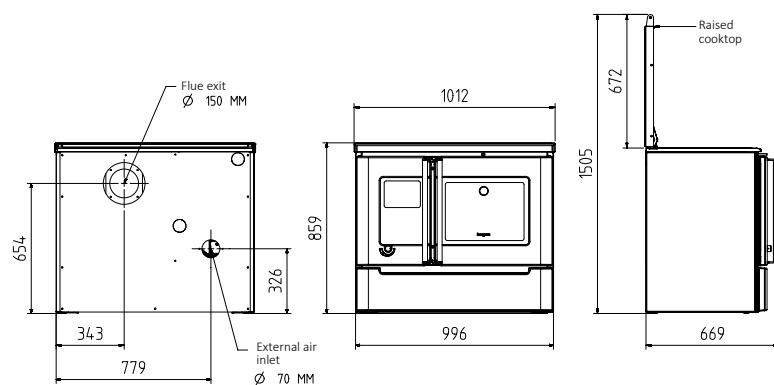

Central heating fireplaces

Hergóm's central heating fireplaces allow you to heat your entire home while you enjoy the warmth of the fire in your living room. The wood fireplace features a water tank that connects to the house's radiators and hot water network. As a result of Hergóm's technological development, central heating fireplaces are the ultimate step towards energy independence, allowing you to obtain heating and hot water through a green, economical and abundant fuel. By using it as a single heat source, or combining it with a conventional boiler, you can save up to 40% in your heating bills. All central heating fireplaces by Hergóm are CE certified (Norm UNE-EN 13229) with its certification number, power and efficiency.



Hergóm's central heating fireplaces may be installed as a single heat source for the house, or in combination with a gas, oil or biomass boiler. The fireplace may be used just for heating or to produce hot water.



Electronic regulation (optional)

The electronic regulation controls the start and stop of the circulation pump, according to the required temperature, set by a thermostat with safety system against overheating. It also controls the communication between the fireplace and the boiler.



Installation kit (optional)

The hydraulic kit can be installed in a fireplace-only heating system or in combination with a conventional central boiler.

It includes:

- Electronic controls (optional)
- Thermic 3-way valve
- Retention valve
- Circulation pump
- Expansion tank
- Manometer
- Safety valve

DERO



- Full glass, cast iron front fireplace.
- Nominal heat output 34,9 kW.
- Thermostatic combustion regulation, according to the temperature set for circulating water.
- Compatible with electronic regulation for a total control in case of an installation that combines the fireplace with an external boiler.
- Optional thermostatic valve and cooling coil.
- Ash pan.
- Adjustable feet for a leveled installation.
- Steel frame included.

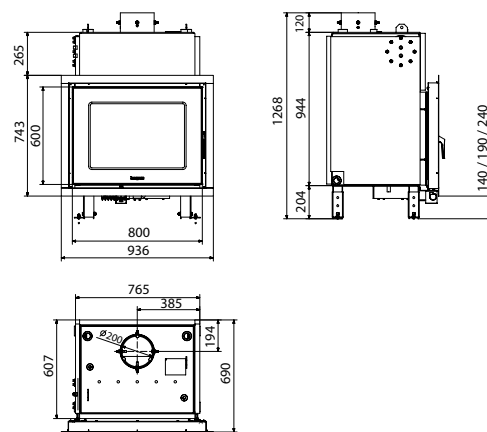

H-02/22



- Cast iron front fireplace.
- Nominal heat output 25 kW.
- Primary air regulation.
- Compatible with electronic regulation for a total control in case of an installation that combines the fireplace with an external boiler.
- Front removable ash pan.

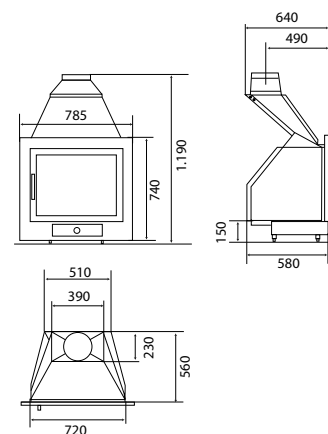

H-03/80 BOILER



- Cast iron front fireplace.
- Nominal heat output 25 kW.
- Primary air regulation.
- Compatible with electronic regulation for a total control in case of an installation that combines the fireplace with an external boiler.
- Front removable ash pan.

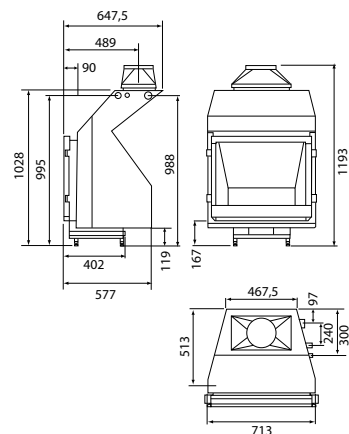

TECHNICAL SPECIFICATIONS

STOVES



Model	GLANCE	GLANCE WALL	MANCHESTER	BENNINGTON	SHELBURNE
Fuel	Wood	Wood	Wood	Wood	Wood
Weight (Kg)	161	150	236	210	180
Flue exit Ø (mm)	150	150	150	150	150
Nominal Power (kW)	7	7	12,6	13	10,5
CO	0,07	0,07	0,10	0,14	0,22
Log length (mm)	300	300	550	550	480
Efficiency	80%	80%	75,2%	75,4%	78%
Clearance to combustibles (Sides/Rear) (mm.)	900/500/150	900/500/*	1.000/500/300	1.000/460/400	1.000/460/610

All stoves are suitable for a 12 mm. hearth.

*To be installed on non-combustible walls only.



Model	CRAFTSBURY	HERITAGE	E-30 L	E-30 M	E-30 S
Fuel	Wood	Wood	Wood	Wood	Wood
Weight (Kg)	130	216	190	150	110
Flue exit Ø (mm)	150	150	200	150	150
Nominal Power (kW)	11,5	16,3	11	9,5	7
CO	0,17	0,20	0,10	0,10	0,10
Log length (mm)	450	540	600	500	400
Efficiency	84,4%	79%	79,3%	79,2%	79,1%
Clearance to combustibles (Sides/Rear) (mm.)	1.000/460/610	1.000/430/400	1.150/450/450	1.150/450/450	1.150/450/450

All stoves are suitable for a 12 mm. hearth.



Model	E-30 XS		E-20 N	SANTORINI	MALLORCA	CRETA
Fuel	Wood	Coal	Wood	Wood	Wood	Wood
Weight (Kg)	100	100	105	180	220	183
Flue exit Ø (mm)	125	125	150	200	300	200
Nominal Power (kW)	4,9	5	8,6	10,5	19	12,7
CO	0,27	0,07	0,17	0,10	0,15	0,26
Log length (mm)	350	-	420	350	400	400
Efficiency	76,7%	80,4%	75%	77,7%	55%	84%
Clearance to combustibles (Sides/Rear) (mm.)	1.150/450/250		920/600/600	500/300/150	750/750/750	500/500/*

All stoves are suitable for a 12 mm. hearth.

*To be installed on non-combustible walls only.

OVENS



Model	LAREDO	LAREDO R
Fuel	Wood	Wood
Weight (Kg)	150	158
Flue exit Ø (mm)	150	150
Nominal Power (kW)	12	12
CO	0,09	0,09
Log length (mm)	500	500
Efficiency	80%	80%
Clearance to combustibles (Sides/Rear) (mm.)	600/600	*

All stoves are suitable for a 12 mm. hearth.

*To be installed on non-combustible walls only.

INSERTS



Model	NATURE 70	NATURE 80	NATURE 100	SERE 70	SERE 80
Fuel	Wood	Wood	Wood	Wood	Wood
Weight (Kg)	90	114	134	95	114
Flue exit Ø (mm)	150	150	200	150	150
Nominal Power (kW)	8,5	10	12	8,9	10
CO	0,09	0,09	0,09	0,09	0,09
Log length (mm)	500	550	700	500	550
Efficiency	75,4%	76%	77,1%	71,3%	73,2%



Model	SERE 100	SERE 100 2C
Fuel	Wood	Wood
Weight (Kg)	134	138
Flue exit Ø (mm)	200	200
Nominal Power (kW)	12	12
CO	0,09	0,26
Log length (mm)	700	700
Efficiency	75%	78,2%

TECHNICAL SPECIFICATIONS

FIREPLACES



Model	HGB-70	STILKAMIN S-460	STILKAMIN S-600	STILKAMIN L	STILKAMIN XL	ECK
Fuel	Wood	Wood	Wood	Wood	Wood	Wood
Weight (Kg)	117	268	258	268	308	256
Flue exit Ø (mm)	150	200	200	250	250	250
Nominal Power (kW)	11	17,5	17,5	21	24	13
CO	0,10	0,09	0,13	0,13	0,13	0,12
Log length (mm)	500	600	600	780	950	650
Efficiency	80%	79%	77%	76%	75%	75%

RANGE COOKERS



Model	CARES
Fuel	Wood
Oven dimensions (mm)	450 x 385 x 450
Weight (Kg)	225
Flue exit Ø (mm)	150
Nominal Power (kW)	11
CO	0,06
Log length (mm)	350
Efficiency	77,6%
Clearance to combustibles (Sides/Rear) (mm.)	400/400

CENTRAL HEATING FIREPLACES



Model	DERO	H-02/22	H-03/80 BOILER
Fuel	Wood	Wood	Wood
Weight (Kg)	271	223	210
Flue exit Ø (mm)	200	200	200
Nominal Power (kW)	34,9	25	25
Power to air (kW)	13,9	7	7
Power to water (kW)	21	18	18
CO	0,11	0,22	0,22
Log length (mm)	500	500	500
Efficiency	72,8%	70%	70%

This technical information is for orientative purposes only. Always check each product's specific instruction manual before installation.



Green heat

Wood is a natural, renewable and “CO2 neutral” fuel.

When you burn wood in a high efficiency Hergóm fireplace, the amount of CO2 released into the atmosphere is higher than if it had followed its natural process of decomposition in the forest. The ratio of CO2 produced in the combustion is so low that the trees themselves absorb it through photosynthesis, transforming carbon back into wood. Contrary to what happens with fossil fuels, this absorption-release cycle can be repeated indefinitely, without producing an excess of CO2. According to estimates by the Environmental Protection Agency of the United States, an increase in the amount of fuel from biomass would significantly reduce the impact of greenhouse gases on the planet.

All Hergóm products are certified by the EC brand, which guarantees their performance in terms of efficiency and thermal values. Still, we work hard to overcome the strictest international controls, far exceeding the minimum requirements regarding performance, CO emissions and particles. By using wood as a fuel in a Hergóm hearth with maximum efficiency, you will be contributing to a cleaner and more sustainable world.

UK SOLE IMPORTER

EUROSTOVE LIMITED

Unit H1
Mendip Industrial Estate
Mendip Road
Rooksbridge
Somerset
BS26 2UG

tel. 01934 750 500 | fax. 01173 156207
web: www.eurostove.co.uk
e-mail: info@eurostove.co.uk

hergom

Industrias Hergóm, S.A. - 39110 SOTO DE LA MARINA (Cantabria)
Apartado de Correos, 208 de Santander - 39080 Santander (Spain)
Tel.: 942 58 70 00 Fax: 942 58 70 01
e-mail: hergom@hergom.com

*Industrias Hergóm, S.A. keeps the right of modifying its products without prior notification.
Availability of products may vary for your specific country.
Warranty and insurance conditions may vary for your specific country.
© Copyright Hergóm 2016.*

hergom.com

